

35mm LANDSCAPING TEAMTURF OVER COMPACTED BASECOURSE

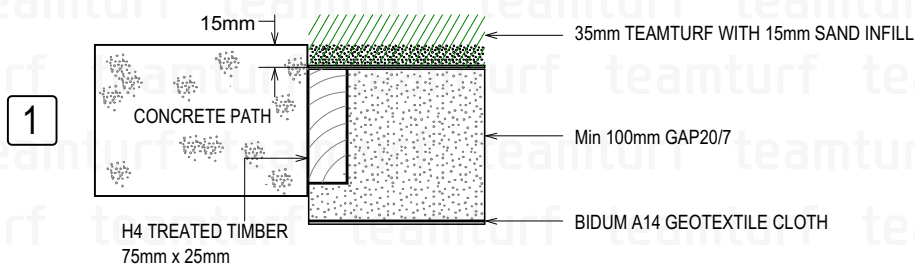

30mm TEAMTURF OVER 70mm PROPLAY PAD + COMPACTED BASECOURSE 3.09m CFH

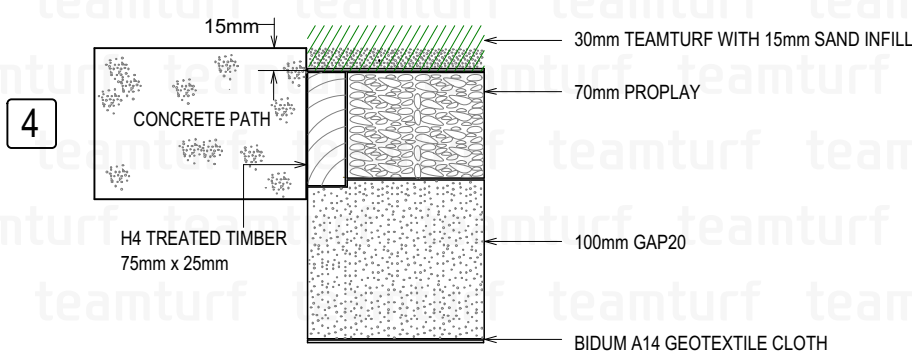

23mm TEAMTURF COOLPLAY OVER 25mm PROPLAY PAD + COMPACTED BASECOURSE 1.69m CFH

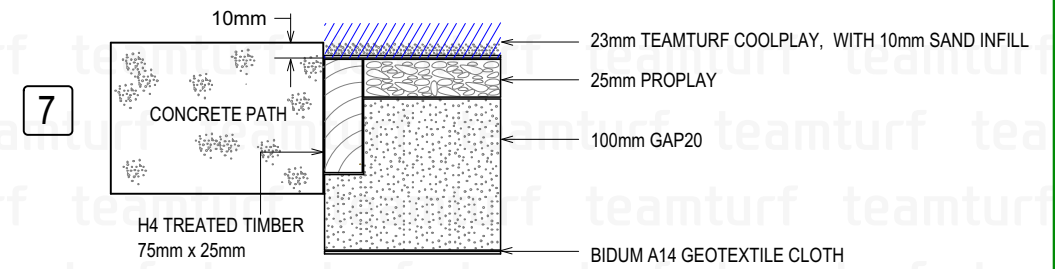

23mm TEAMTURF COOLPLAY OVER 35mm PROPLAY PAD + COMPACTED BASECOURSE 1.8m CFH

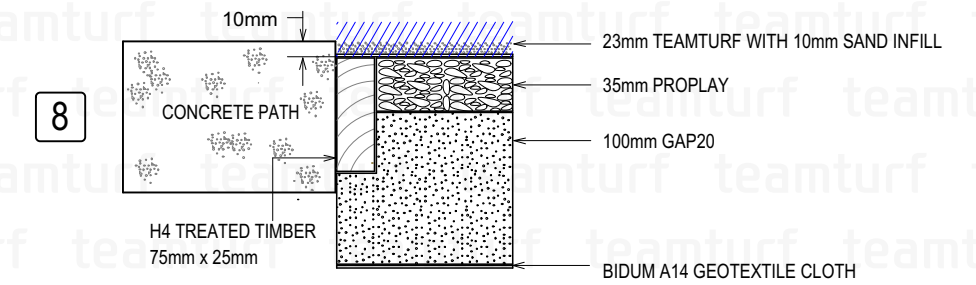

30mm TEAMTURF OVER 25mm PROPLAY PAD + COMPACTED BASECOURSE 1.69m CFH

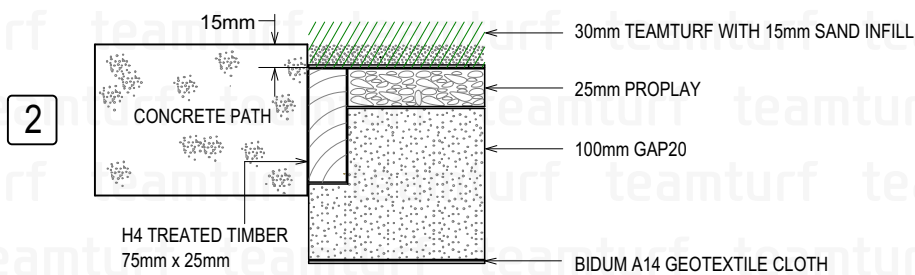

30mm TEAMTURF UP AGAINST MULCH/GRASS

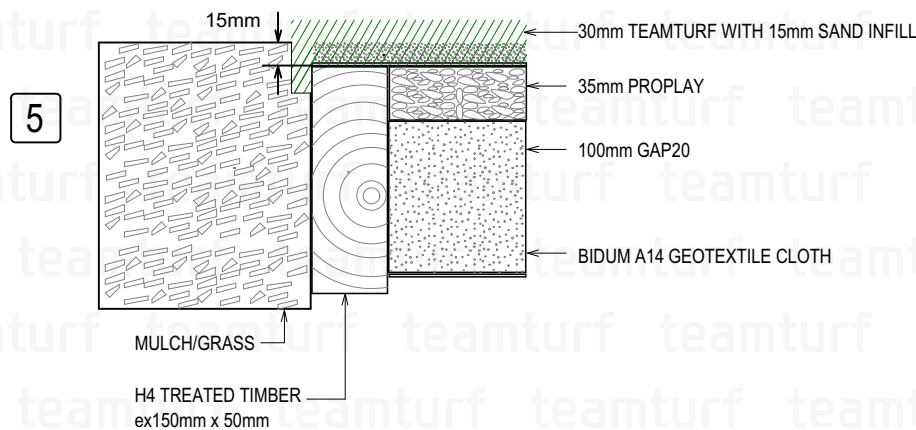

23mm TEAMTURF COOLPLAY OVER 70mm PROPLAY PAD + COMPACTED BASECOURSE 2.96m CFH

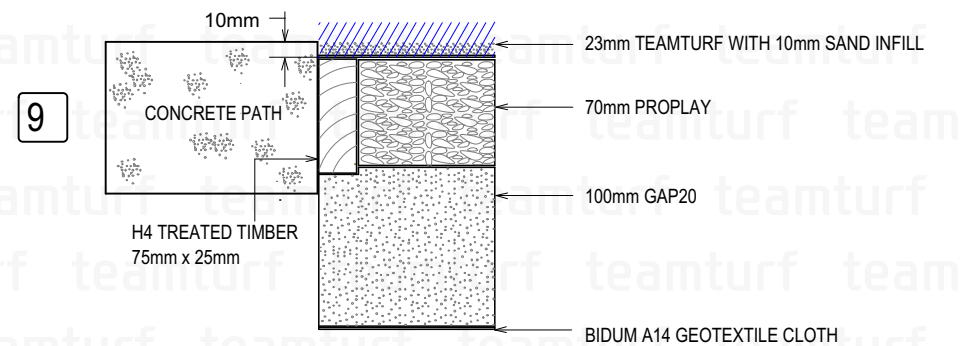

30mm TEAMTURF OVER 35mm PROPLAY PAD + COMPACTED BASECOURSE 2.04m CFH

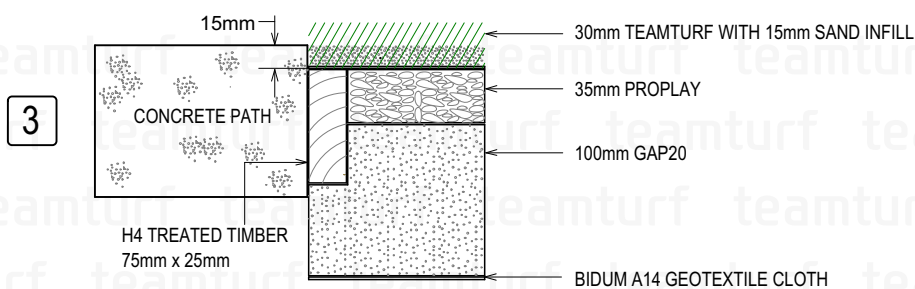

30mm TEAMTURF UP AGAINST EXPOSED TIMBER EDGE

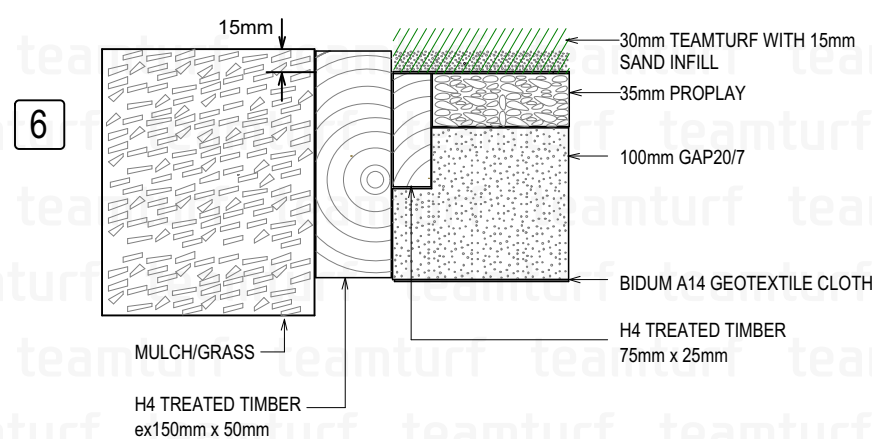

30mm TEAMTURF TRANSITION FROM PAD TO COMPACTED BASECOURSE.

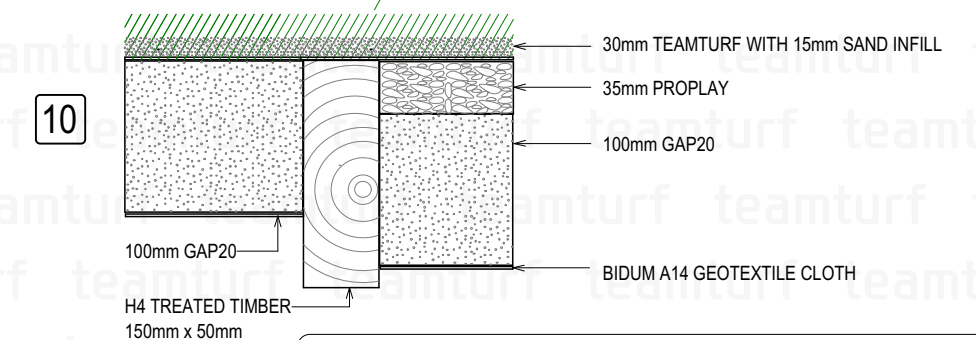

Concrete footings, paths, shown are indicative, and to be used as a guide only. All foundations will require specific engineering which is the design responsibility of the main contractor or equipment installer. Teamturf accepts no responsibility for any work undertaken which has not been adhered to within the guidelines of these details. If in doubt or you have queries please ask !!!